

NOTICE OF PROPRIETARY RIGHTS: THIS DRAWING CONTAINS CONFIDENTIAL INFORMATION PROPRIETARY TO Somefly technology Co.,Ltd.  
 IT MUST NOT BE REPRODUCED OR DISCLOSED TO OTHERS OR USED IN ANY OTHER WAY, IN WHOLE OR PART EXCEPT AS AUTHORIZED  
 IN WRITING BY Somefly technology Co.,Ltd.

RoHS compliant

SYM	REVISION	DESCRIPTION	DFTM	DATE	APPD	APPD

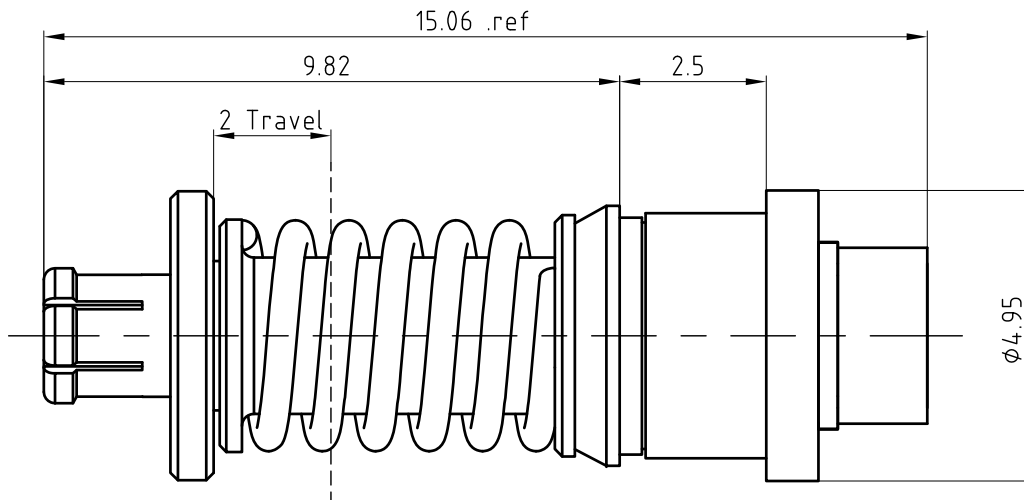

NOTES:  
 1. MATERIALS AND FINISHES:  
 BODY - STAINLESS STEEL , PASSIVATED  
 OUTER CONTACT - BERYLLIUM COPPER, GOLD PLATING  
 INNER CONTACT - BERYLLIUM COPPER, GOLD PLATING  
 INSULATOR - PTFE, NATURAL  
 2. ELECTRICAL:  
 A. IMPEDANCE: 50 OHM  
 B. FREQUENCY RANGE: DC - 40 GHz  
 C. VSWR: 1.40 MAX. @ DC - 40GHz  
 D. INSERTION LOSS: 0.8 dB MAX.

3. MECHANICAL:  
 A. DURABILITY: 100 CYCLES MIN (FD)  
 500 CYCLES MIN (SB).  
 B. TEMPERATURE RANGE: -65°C to 165°C  
 C. COMPATIBLE WITH ALL STANDARD: IEC61169-60  
 ANSI VITA 67.3-2022

CUSTOMER OUTLINE DRAWING  
 ALL OTHER SHEETS ARE FOR INTERNAL USE ONLY

MATERIAL:	UNLESS OTHERWISE SPECIFIED		DFTM: Huang		Somefly technology Co.,Ltd	
	ALL DIMENSIONS ARE IN mm MACHINED SURFACES FINISH 1.6RMS MAX. REMOVE ALL BURRS 0.15x45°MAX. BREAK MACHINE CORNERS 0.15x45°D MAX. FILLET R. TOLERANCES ON DECIMALS .X ±0.2 .XX ±0.1 ANGLES: ±2° FRACTIONS ±N/A		DATE: 2023.07.01		SMPM Female VITA 67.3 Backplane Contact for .086" Cable	
			CHKD HeTong		DATE: 2023.07.01	
USED ON:	DO NOT SCALE DRAWING		APPD: Stone		SMPM-K32H,VITA67.3	
SCALE: 8/1	DWG SIZE: A4	SURFACE (mm <sup>2</sup> ): xx	WEIGHT (g): xx	DATE: 2023.07.01	SHT	005-SC3H0N-NS REV A.1