

NOTICE OF PROPRIETARY RIGHTS: THIS DRAWING CONTAINS CONFIDENTIAL INFORMATION PROPRIETARY TO Somefly technology Co.,Ltd.
IT MUST NOT BE REPRODUCED OR DISCLOSED TO OTHERS OR USED IN ANY OTHER WAY, IN WHOLE OR PART EXCEPT AS AUTHORIZED
IN WRITING BY Somefly technology Co.,Ltd.

RoHS compliant

SYM	REVISION	DESCRIPTION	DFTM	DATE	APPD	APPD

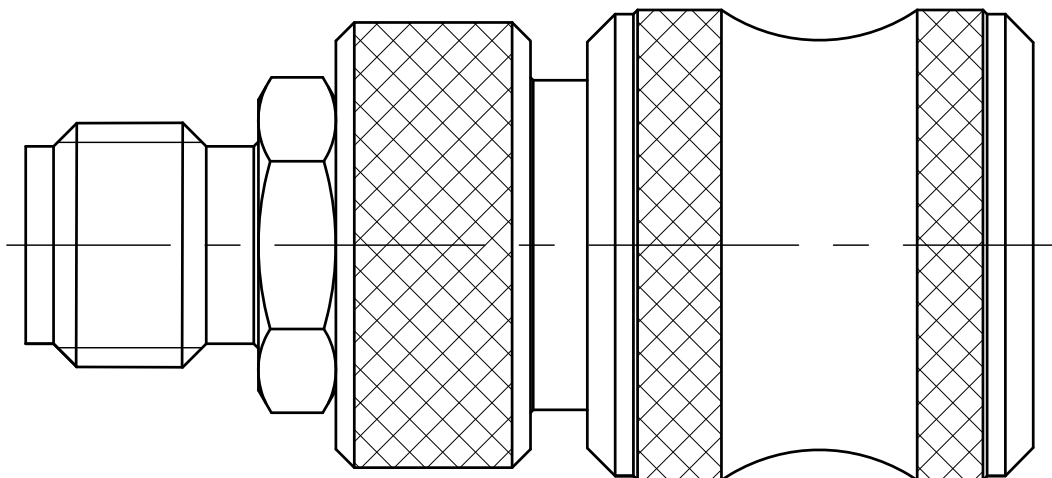

NOTES:

1. MATERIALS AND FINISHES:
 A. BODY - STAINLESS STEEL PASSIVATION
 B. OUTER CONTACT - BERYLLIUM, NICKEL PLATING
 C. INNER CONTACT - BERYLLIUM COPPER, GOLD PLATING
 D. INSULATOR - PEI
2. ELECTRICAL:
 A. IMPEDANCE: 50 OHM
 B. FREQUENCY RANGE: DC - 40 GHz
 C. VSWR: 1.25 MAX.
 D. INSERTION LOSS: 0.6dB MAX.
 E. VOLTAGE RATING: 500 VRMS
 F. DIELECTRIC WITHSTANDING VOLTAGE: 2000 VRMS MIN.
 G. INSULATION RESISTANCE: 5000 MΩ MIN.
 H. INTERMODULATION 3RD ORDER: N/A dBc MAX. (2 X 43 dBm)

3. MECHANICAL:
 A. DURABILITY: 500 CYCLES MIN.
 B. TEMPERATURE RANGE: -40°C TO +85°C
 C. COMPATIBLE WITH ALL STANDARD: IEC61169-35
4. PACKAGING:
 A. QUANTITY: PACK 10PCS
 B. MARKING: TRAY TO BE MARKED ""

CUSTOMER OUTLINE DRAWING
ALL OTHER SHEETS ARE FOR INTERNAL USE ONLY

MATERIAL:	UNLESS OTHERWISE SPECIFIED		DFTM: 006	Somefly technology Co.,Ltd			
	ALL DIMENSIONS ARE IN mm MACHINED SURFACES FINISH 1.6RMS MAX. REMOVE ALL BURRS 0.15x45° MAX. BREAK MACHINE CORNERS 0.15x45° D MAX. FILLET R. TOLERANCES ON DECIMALS .X ±0.2 .XX ±0.1 ANGLES: ±2° FRACTIONS: ±N/A		DATE: 2022.05.15				
	USED ON:			CHKD HeTong	2.92 Male to Female Quick-Connect Adaptor 2.92-JKQ		
SCALE: 5/1	DWG SIZE: A4	DO NOT SCALE DRAWING	DATE: 2022.05.15	SHT		097-K5006-CSQ	REV